

REVISIONS		
REV	DESCRIPTION	DATE

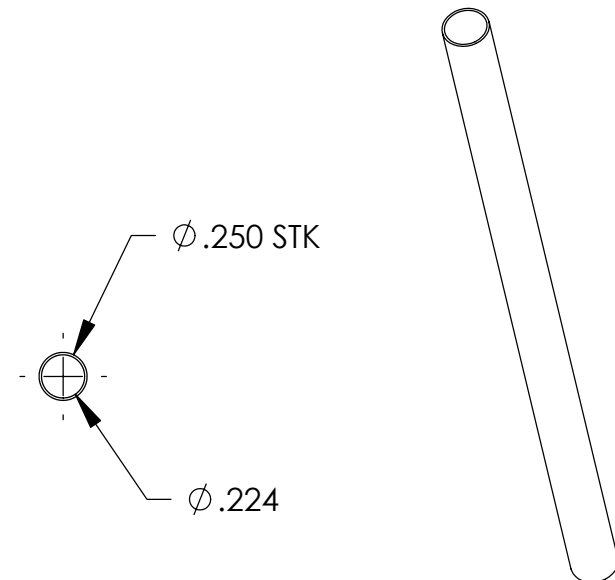
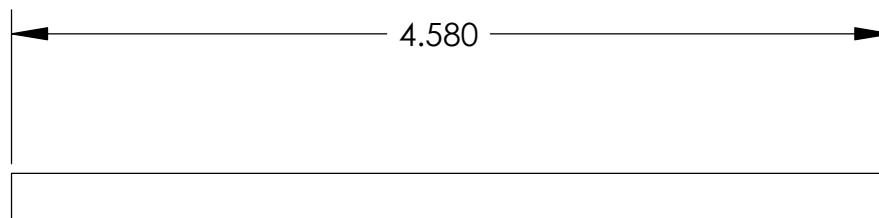

NOTES:
1. MAKE FROM .250 X .013" WALL TUBING.

UNLESS OTHERWISE SPECIFIED:						<div>High Precision Devices</div> <div>1668 Valtec Lane, Suite C, Boulder, Colorado 80301 Phone: (303) 447-2558 Fax: (303) 447-2548 Web Site: www.hpd-online.com</div>					
DIMENSIONS ARE IN INCHES DECIMAL TOLERANCES: .X ±.030 .XX ±.015 .XXX ±.005											
ANGULAR TOL: ± 1° SURFACE ROUGHNESS:√63/						TITLE: <div>p02101-141 tube, support</div>					
INTERNAL AND EXTERNAL SURFACE INTERSECTIONS SHALL BE UNIFORMLY FINISHED WITH CHAMFER .005/.010 X 45° OR RADIUS .005/.010. CHAMFER ALL THREADED HOLES 110° OF MAJOR DIAMETER X 45°											
CONFIGURATION: 00-Default											
MATERIAL: 304 SST			SIZE	QTY PER ASSM: 12	SCALE: 1:1	SHEET 1 OF 1			REV		
FINISH: NONE			A	DATE: 5/20/2004	DRAWN BY: C. Danaher			A			